

Night work and traffic changes on Princes Highway, St Peters

Work will be carried out to install and relocate concrete barriers on the Princes Highway near the intersection of Campbell Street. Road closures and traffic detours are necessary to carry out this work. Work will be conducted at night when traffic volumes are lower for the safety for workers, motorists, cyclists and pedestrians.

Traffic changes

Wednesday 24 January 7pm to 5am

Work will be carried out on the eastern verge of Princes Highway between Campbell Street and Albert Street to relocate concrete barriers to reinstate the three southbound traffic lanes on Princes Highway.

During this work:

- Campbell Street (east) will be closed between Princes Highway and Crown Street. No entry or exit into Campbell Street (east) from Princes Highway
- Local access to Crown Street during this time will be via Barwon Park Road and Campbell Road
- Right turn from Campbell Street (east) to Crown Street will be permitted during this time.

Wednesday 31 January 9pm to 5am

Work will be carried out on the western verge of Princes Highway between Campbell Street and Victoria Street to install additional concrete barriers.

During this work:

- No access from Princes Highway to Victoria Street due to traffic control set up on Princes Highway
- Access to Victoria Street and Church Street via May Street southbound and Campbell Street (west)
- Access to Brown Street via Conway Place or May Street southbound and Campbell Street (west)
- Access to Florence Street via Silver Street or May Street southbound and Campbell Street (west)
- Access to Hutchinson Street via Conway Place and Brown Street or May Street southbound and Campbell Street (west)
- Left turn only permitted from Church Street, St Peters Street, Florence Street and Brown Street to Campbell Street. This will be in place for the duration of works
- Access to Crown Street via Barwon Park Road and Campbell St (east)
- Right turn from Campbell Street (east) to Crown Street will be permitted during this time.

Two way traffic will be maintained by traffic control on Princes Highway during night work shifts. Please allow for delays while this night work is being carried out.

Equipment used during night work will include a crane, trucks, light vehicles, lighting tower and hand tools. There will be no concrete saw cutting or jackhammering associated with this concrete barrier installation and relocation.

Minimising community impact

The work is expected to create some noise impacts to nearby residents. Every effort will be made to minimise noise and light spill associated with this work by:

- turning off equipment and vehicles when not in use
- using non-tonal reversing beepers on all machinery during night work
- directing noise generating equipment and lights away from residential properties where possible

For more information

✉ info@newm5.com.au

☎ 1800 660 248

🌐 westconnex.com.au



Constructed by





Easing congestion



Creating jobs



Connecting communities

Traffic control will be in place to manage road users through the changes.

More information

If you have any questions about this work, please call 1800 660 248 and ask to speak to a member of the New M5 Community Engagement Team or email info@newm5.com.au

Location of night work

Princes Highway

Wednesday 24 January 2018



Location of night work

Princes Highway

Wednesday 31 January 2018

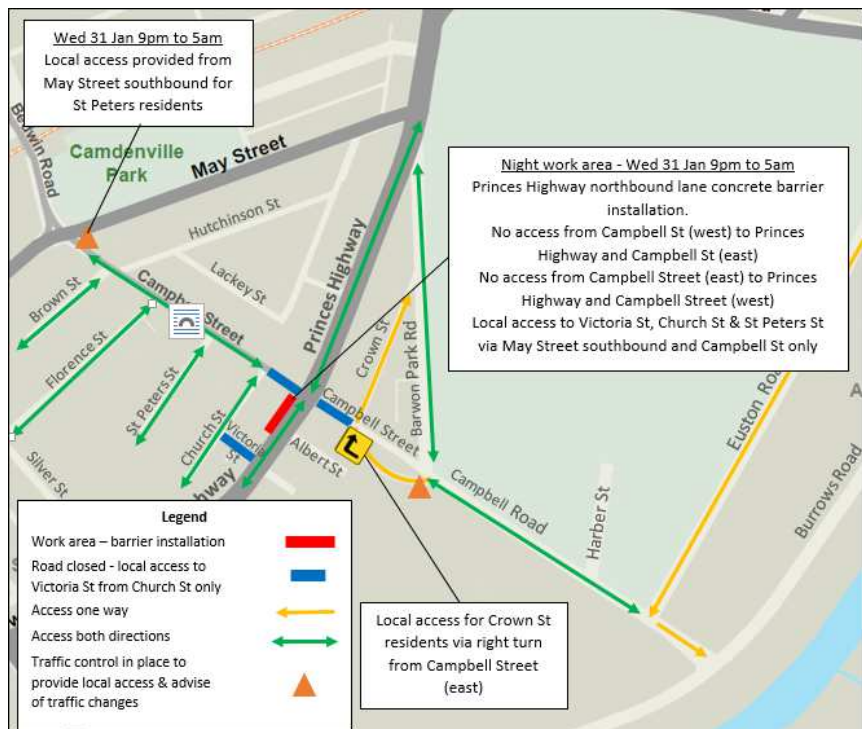

Notification No. 345