

16 August 2017

Night work – Installation of Intelligent Transport System at Princes Highway, St Peters

Work is underway to widen Campbell Street and Campbell Road between Bedwin Road and Burrows Road. As part of this work, night work will be undertaken along Princes Highway at the intersection of Campbell Street, (east) St Peters to facilitate the installation of the Intelligent Transport System (ITS). This will result in the Campbell Street (east) signals going to a much improved sensor system rather than the current automatic timed system. This work is being undertaken at night under traffic management for the safety of workers, motorists, pedestrians and cyclists.

Timing of works

Night work will be carried out from **Monday 21 August 2017** and will take place, weather permitting between **8pm and 4.30am**. If the work is not completed, night work will be carried out on **Tuesday 22 August** between **8pm and 4.30am**.

Traffic impacts

Location	Date and time	Traffic impacts and Pedestrian Access
Campbell Street and Campbell Road between Princes Highway and Burrows Road	Monday 21 August 8pm to 4.30am	<ul style="list-style-type: none"> • Full closure of Campbell Street (east) from Princes Highway to Barwon Park Road • No entry or exit into Campbell Street (east) from Princes Highway. • Crown Street, Campbell Street and Barwon Park Road residents should enter via Barwon Park Road and Campbell Street and exit via Barwon Park Road • Euston Road residents and businesses should exit out of Burrows Road via Campbell Road • Temporary lane closures on the Princes Highway southbound. Traffic will be maintained in both directions • Traffic lights at the intersection of Princes Highway and Campbell Street (east) will be inactivated under traffic control • Footpath closure and detours • Reduced speed limit • Refer to overleaf for location and detour route.
	Tuesday 22 August 8pm to 4.30am (Contingency)	

Traffic control and signage will be in place to assist road users, pedestrians and cyclists through the changes. If you are travelling through the area, please allow extra time for your journey and follow the signs and directions from traffic controllers.

The work will involve:

- Setting up a safe work area and traffic management.
- Duct and installation across the intersection
- Pulling the ITS cable and commissioning the signals.

Equipment used during the work will include an excavator, compactor, concrete saw/corer, tip and vac trucks, rock breaker, power tools, lighting towers, construction vehicles and traffic management.

Minimising community impact

Every effort will be made to minimise noise and light spill associated with this work by:

- scheduling noisy work to take place early in the night where possible
- turning off equipment and vehicles when not in use

For more information



Easing
congestion



Creating
jobs



Connecting
communities

- using non-tonal reversing beepers on all machinery
- directing noise generating equipment and lights away from residential properties where possible
- eco barriers will be in place to reduce noise
- notifying residents and businesses before work starts near their property.

If you have a question about this work, please call 1800 660 248 and ask to speak to a member of the New M5 community engagement team or email info@newm5.com.au. You can also visit the New M5 Community Information Centre located at 27 Burrows Road, St Peters. The centre is open on weekdays from 9am to 5pm.

Detour Map: 21 August 2017

Local access detour map – Campbell Street/Campbell Road and surrounding streets

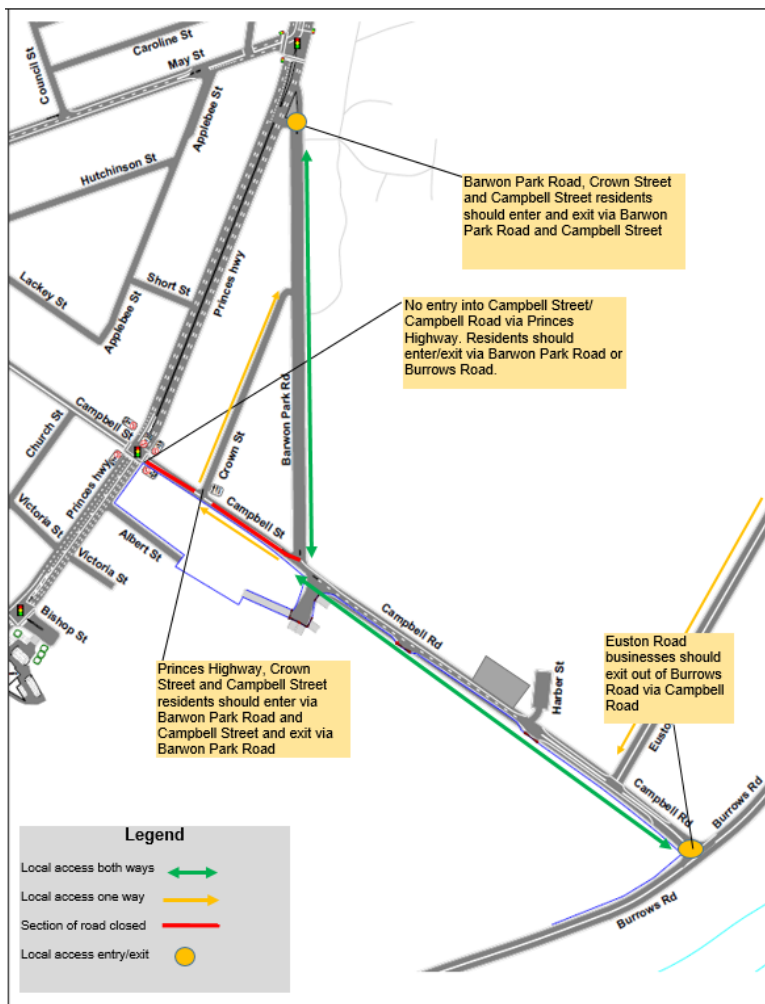

Notification No: 255



We speak your language

To learn more simply visit westconnex.com.au/yourlanguage.

Need an interpreter? Call the Translating and Interpreting Service on **131 450**